

# SUPERIOR

WASHER & GASKET CORP.

Part Number	Material	OD	ID	Free HT	Size	Thickness	
BB02-375025	=Stainless-Steel-410	.373/.377	.091/.095	.058/.06		.025	Belleville
BB02-250015	=Stainless-Steel-410	.245/.255	.092/.097	.026/.03		.015	Belleville
BB02-182006	=Stainless-Steel-410	.177/.187	.093/.103	.013		.006	Belleville
BB02-182010	=Stainless-Steel-410	.177/.187	.093/.103	.015		.010	Belleville
BB03-302012	=Stainless-Steel-410	.300/.305	.109/.112	.050/.06		.012	Belleville
BB04-242031	=Stainless-Steel-410	.242	.122	.047		.031	Belleville
BB04-245009	=Stainless-Steel-410	.240/.250	.125/.135	.017		.009	Belleville
BB04-245013	=Stainless-Steel-410	.240/.250	.125/.135	.020		.013	Belleville
BB04-370018	=Stainless-Steel-410	.365/.375	.125/.135	.029		.018	Belleville
BB04-245008	=Stainless-Steel-410	.245	.129	.021		.008	Belleville
BB04-300013	=Stainless-Steel-410	.295/.305	.129/.136	.036/.05		.013	Belleville
BB04-246007	=Stainless-Steel-410	.246	.132	.020		.007	Belleville
BB04-250020	=Stainless-Steel-410	.250	.132	.045		.020	Belleville
BB06-375025	=Stainless-Steel-410	.365/.385	.138/.143	.055/.07		.025	Belleville
BB06-278015	=Stainless-Steel-410	.278	.139	.029		.015	Belleville
BB06-277020	=Stainless-Steel-410	.277	.142	.037		.020	Belleville
BB06-277014	=Stainless-Steel-410	.277	.144	.024		.014	Belleville
BB06-278012	=Stainless-Steel-410	.278	.144	.033		.010	Belleville
BB06-300012	=Stainless-Steel-410	.300	.145	.053		.012	Belleville
BB06-320025	=Stainless-Steel-410	.320	.147	.049		.025	Belleville
BB06-312015	=Stainless-Steel-410	.312	.155	.026		.015	Belleville
BB06-307010	=Stainless-Steel-410	.302/.312	.156/.166	.021		.010	Belleville
BB06-307016	=Stainless-Steel-410	.302/.312	.156/.166	.025		.016	Belleville
BB06-313016	=Stainless-Steel-410	.313	.157	.028		.016	Belleville
BB06-308010	=Stainless-Steel-410	.308	.160	.024		.010	Belleville
BB06-308023	=Stainless-Steel-410	.308	.160	.035		.023	Belleville
BB08-437031	=Stainless-Steel-410	.433/.443	.164/.170	.062/.07		.031	Belleville
BB08-341017	=Stainless-Steel-410	.341	.165	.033		.017	Belleville
BB08-100064	=Stainless-Steel-410	1.000	.166	.220		.064	Belleville
BB06-406018	=Stainless-Steel-410	.396/.416	.170/.180	.040/.06		.018	Belleville

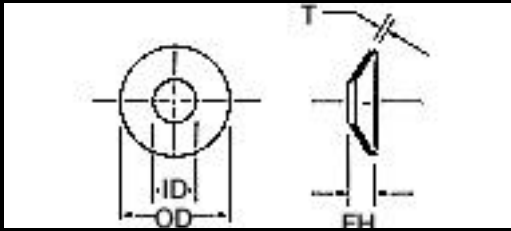

# SUPERIOR

WASHER & GASKET CORP.

Part Number	Material	OD	ID	Free HT	Size	Thickness	
BB08-339018	=Stainless-Steel-410	.339	.171	.035		.018	Belleville
BB08-348040	=Stainless-Steel-410	.348	.174	.095		.040	Belleville
BB08-438040	=Stainless-Steel-410	.438	.174	.056		.042	Belleville
BB08-500030	=Stainless-Steel-410	.500	.180	.058		.030	Belleville
BB08-510030	=Stainless-Steel-410	.511	.180	.048		.028	Belleville
BB10-132032	=Stainless-Steel-410	1.321	.190	.046		.032	Belleville
BB10-562040	=Stainless-Steel-410	.552/.572	.190/.195	.070/.09		.040	Belleville
BB10-370015	=Stainless-Steel-410	.365/.375	.190/.200	.027		.015	Belleville
BB10-370018	=Stainless-Steel-410	.365/.375	.190/.200	.028		.018	Belleville
BB10-370020	=Stainless-Steel-410	.365/.375	.190/.200	.030		.020	Belleville
BB10-557028	=Stainless-Steel-410	.552/.562	.190/.200	.042		.028	Belleville
BB10-313015	=Stainless-Steel-410	.313	.192	.031		.015	Belleville
BB10-366008	=Stainless-Steel-410	.366	.192	.028		.008	Belleville
BB10-373013	=Stainless-Steel-410	.373	.194	.030		.013	Belleville
BB10-373019	=Stainless-Steel-410	.373	.194	.030		.019	Belleville
BB10-374015	=Stainless-Steel-410	.374	.195	.030		.015	Belleville
BB10-480015	=Stainless-Steel-410	.480	.195	.036		.015	Belleville
BB10-559030	=Stainless-Steel-410	.559	.196	.045		.030	Belleville
BB10-373020	=Stainless-Steel-410	.373	.198	.034		.020	Belleville
BB10-371015	=Stainless-Steel-410	.371	.202	.027		.015	Belleville
BB10-439018	=Stainless-Steel-410	.439	.202	.035		.018	Belleville
BB10-560027	=Stainless-Steel-410	.560	.202	.040		.027	Belleville
BB10-421029	=Stainless-Steel-410	.421	.205	.070		.029	Belleville
BB10-503008	=Stainless-Steel-410	.503	.206	.095		.008	Belleville
BB10-426034	=Stainless-Steel-410	.426	.207	.055		.034	Belleville
BB10-428031	=Stainless-Steel-410	.428	.208	.068		.031	Belleville
BB10-596017	=Stainless-Steel-410	.596	.208	.075		.017	Belleville
BB10-424040	=Stainless-Steel-410	.424	.215	.058		.040	Belleville
BB10-500026	=Stainless-Steel-410	.500	.222	.042		.026	Belleville
BB14-750025	=Stainless-Steel-410	.740/.760	.250/.255	.035/.04		.025	Belleville

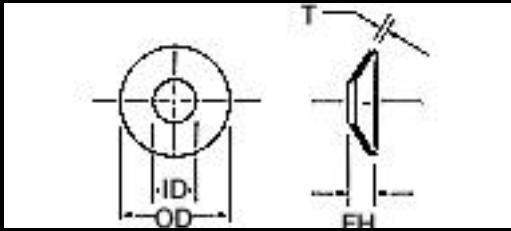

# SUPERIOR

WASHER & GASKET CORP.

Part Number	Material	OD	ID	Free HT	Size	Thickness	
BB14-750062	=Stainless-Steel-410	.740/.760	.250/.255	.090/.11		.062	Belleville
BB14-437020	=Stainless-Steel-410	.437	.253	.050		.020	Belleville
BB14-494020	=Stainless-Steel-410	.495	.253	.034		.020	Belleville
BB14-751040	=Stainless-Steel-410	.751	.253	.066		.040	Belleville
BB14-437016	=Stainless-Steel-410	.432/.442	.253/.260	.040/.05		.016	Belleville
BB14-495018	=Stainless-Steel-410	.490/.500	.255/.265	.034		.018	Belleville
BB14-495022	=Stainless-Steel-410	.490/.500	.255/.265	.036		.022	Belleville
BB14-495025	=Stainless-Steel-410	.490/.500	.255/.265	.038		.025	Belleville
BB14-495038	=Stainless-Steel-410	.495/.500	.255/.265	.047		.038	Belleville
BB14-745036	=Stainless-Steel-410	.740/.750	.255/.265	.054		.036	Belleville
BB14-562015	=Stainless-Steel-410	.552/.572	.256/.267	.031/.04		.015	Belleville
BB14-496018	=Stainless-Steel-410	.496	.257	.038		.018	Belleville
BB14-498060	=Stainless-Steel-410	.498	.257	.085		.060	Belleville
BB14-498026	=Stainless-Steel-410	.498	.258	.058		.026	Belleville
BB14-750016	=Stainless-Steel-410	.750	.258	.054		.016	Belleville
BB14-437040	=Stainless-Steel-410	.437	.260	.054		.040	Belleville
BB14-483020	=Stainless-Steel-410	.483	.260	.034		.020	Belleville
BB14-498024	=Stainless-Steel-410	.498	.260	.040		.024	Belleville
BB14-499061	=Stainless-Steel-410	.499	.260	.075		.061	Belleville
BB14-740040	=Stainless-Steel-410	.730/.745	.260/.270	.080/.10		.040	Belleville
BB14-501015	=Stainless-Steel-410	.501	.261	.041		.015	Belleville
BB14-501022	=Stainless-Steel-410	.501	.261	.040		.022	Belleville
BB14-449015	=Stainless-Steel-410	.449	.265	.024		.015	Belleville
BB14-505005	=Stainless-Steel-410	.565	.265	.038		.025	Belleville
BB14-490020	=Stainless-Steel-410	.490	.273	.035		.020	Belleville
BB14-500016	=Stainless-Steel-410	.500	.273	.044		.016	Belleville
BB14-952076	=Stainless-Steel-410	.952	.273	.100		.076	Belleville
BB16-500050	=Stainless-Steel-410	.490/.510	.281/.286	.080/.09		.050	Belleville
BB16-750075	=Stainless-Steel-410	.750	.282	.099		.075	Belleville
BB16-493048	=Stainless-Steel-410	.493	.314	.078		.048	Belleville

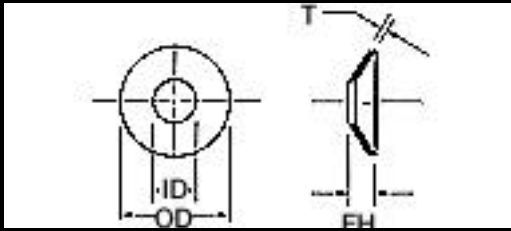

# SUPERIOR

WASHER & GASKET CORP.

Part Number	Material	OD	ID	Free HT	Size	Thickness	
BB16-600031	=Stainless-Steel-410	.600	.316	.043		.031	Belleville
BB16-628058	=Stainless-Steel-410	.628	.316	.082		.058	Belleville
BB18-620022	=Stainless-Steel-410	.615/.625	.317/.327	.042		.022	Belleville
BB18-620032	=Stainless-Steel-410	.615/.625	.317/.327	.048		.032	Belleville
BB18-932045	=Stainless-Steel-410	.927/.937	.317/.327	.067		.045	Belleville
BB18-625032	=Stainless-Steel-410	.625	.320	.050		.032	Belleville
BB18-625030	=Stainless-Steel-410	.625	.320	.062		.031	Belleville
BB18-493050	=Stainless-Steel-410	.493	.322	.073		.050	Belleville
BB18-500010	=Stainless-Steel-410	.500	.323	.020		.010	Belleville
BB18-609013	=Stainless-Steel-410	.609	.324	.071		.013	Belleville
BB18-620030	=Stainless-Steel-410	.620	.324	.047		.030	Belleville
BB18-620050	=Stainless-Steel-410	.620	.324	.067		.050	Belleville
BB18-719028	=Stainless-Steel-410	.719	.324	.050		.028	Belleville
BB18-812075	=Stainless-Steel-410	.812	.324	.106		.075	Belleville
BB18-624056	=Stainless-Steel-410	.624	.340	.017		.056	Belleville
BB18-625009	=Stainless-Steel-410	.625	.376	.034		.009	Belleville
BB20-755050	=Stainless-Steel-410	.755	.380	.064		.050	Belleville
BB20-745028	=Stainless-Steel-410	.740/.750	.380/.390	.051		.028	Belleville
BB20-745034	=Stainless-Steel-410	.740/.750	.380/.390	.055		.034	Belleville
BB20-745040	=Stainless-Steel-410	.740/.750	.380/.390	.059		.040	Belleville
BB20-745056	=Stainless-Steel-410	.740/.750	.380/.390	.070		.056	Belleville
BB20-112053	=Stainless-Steel-410	1.115/1.125	.380/.390	.080		.053	Belleville
BB20-746040	=Stainless-Steel-410	.746	.381	.067		.040	Belleville
BB20-749033	=Stainless-Steel-410	.749	.383	.052		.033	Belleville
BB20-125065	=Stainless-Steel-410	1.240/1.260	.384/.398	.110/.12		.065	Belleville
BB20-746034	=Stainless-Steel-410	.746	.385	.062		.034	Belleville
BB20-748041	=Stainless-Steel-410	.748	.386	.068		.041	Belleville
BB20-746042	=Stainless-Steel-410	.746	.389	.060		.042	Belleville
BB20-100063	=Stainless-Steel-410	1.002	.389	.120		.063	Belleville
BB20-822022	=Stainless-Steel-410	.822	.395	.127		.022	Belleville

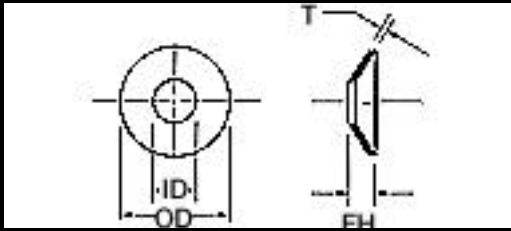

# SUPERIOR

WASHER & GASKET CORP.

Part Number	Material	OD	ID	Free HT	Size	Thickness	
BB20-126062	=Stainless-Steel-410	1.250	.395	.121		.062	Belleville
BB20-120035	=Stainless-Steel-410	1.195/1.205	.395/.400	.093		.035	Belleville
BB20-111078	=Stainless-Steel-410	1.118	.396	.140		.078	Belleville
BB20-109045	=Stainless-Steel-410	1.083/1.103	.396/.406	.131/.14		.045	Belleville
BB20-109041	=Stainless-Steel-410	1.098	.403	.083		.041	Belleville
BB20-791041	=Stainless-Steel-410	.791	.405	.055		.041	Belleville
BB20-793031	=Stainless-Steel-410	.793	.405	.052		.031	Belleville
BB20-865063	=Stainless-Steel-410	.865	.405	.080		.063	Belleville
BB20-870058	=Stainless-Steel-410	.870	.406	.112		.058	Belleville
BB20-876015	=Stainless-Steel-410	.876	.436	.041		.015	Belleville
BB20-101005	=Stainless-Steel-410	1.000	.440	.022		.005	Belleville
BB22-870031	=Stainless-Steel-410	.860/.875	.442/.452	.059		.031	Belleville
BB22-870045	=Stainless-Steel-410	.860/.875	.442/.452	.067		.045	Belleville
BB22-124095	=Stainless-Steel-410	1.248	.465	.128		.095	Belleville
BB22-900045	=Stainless-Steel-410	.900	.481	.071		.045	Belleville
BB22-859016	=Stainless-Steel-410	.859	.483	.030		.016	Belleville
BB22-985060	=Stainless-Steel-410	.985	.483	.080		.060	Belleville
BB22-110025	=Stainless-Steel-410	1.090/1.110	.492/.501	.067		.025	Belleville
BB22-150061	=Stainless-Steel-410	1.500	.503	.124		.061	Belleville
BB24-990035	=Stainless-Steel-410	.985/1.000	.505/.515	.067		.035	Belleville
BB24-990043	=Stainless-Steel-410	.985/1.000	.505/.515	.071		.043	Belleville
BB24-990050	=Stainless-Steel-410	.985/1.000	.505/.515	.075		.050	Belleville
BB24-990073	=Stainless-Steel-410	.985/1.000	.505/.515	.091		.073	Belleville
BB24-995070	=Stainless-Steel-410	.990/1.000	.505/.515	.104		.070	Belleville
BB24-933015	=Stainless-Steel-410	.933	.506	.021		.015	Belleville
BB24-125065	=Stainless-Steel-410	1.250/1.260	.510/.520	.108/.11		.065	Belleville
BB24-100020	=Stainless-Steel-410	.990/1.010	.510/.530	.070/.09		.020	Belleville
BB24-100050	=Stainless-Steel-410	.990/1.010	.510/.530	.090/.12		.050	Belleville
BB24-162040	=Stainless-Steel-410	1.610/1.640	.510/.530	.080/.10		.040	Belleville
BB24-137049	=Stainless-Steel-410	1.376	.562	.070		.049	Belleville

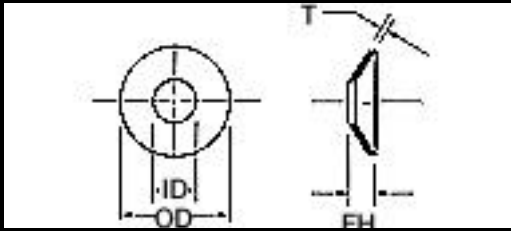

# SUPERIOR

WASHER & GASKET CORP.

Part Number	Material	OD	ID	Free HT	Size	Thickness	
BB26-100017	=Stainless-Steel-410	.985/1.015	.563/.593	.041/.05		.017	Belleville
BB26-112060	=Stainless-Steel-410	1.129	.565	.115		.060	Belleville
BB26-112038	=Stainless-Steel-410	1.115/1.125	.567/.577	.073		.038	Belleville
BB26-112056	=Stainless-Steel-410	1.115/1.125	.567/.577	.084		.056	Belleville
BB26-942016	=Stainless-Steel-410	.942	.573	.036		.016	Belleville
BB28-125040	=Stainless-Steel-410	1.240/1.250	.630/.640	.082		.040	Belleville
BB28-125062	=Stainless-Steel-410	1.240/1.250	.630/.640	.092		.062	Belleville
BB28-187086	=Stainless-Steel-410	1.855/1.875	.630/.640	.129		.086	Belleville
BB28-237062	=Stainless-Steel-410	2.360/2.390	.635/.655	.130/.15		.062	Belleville
BB28-140034	=Stainless-Steel-410	1.410/1.420	.637/.642	.091/.09		.034	Belleville
BB28-138032	=Stainless-Steel-410	1.381	.638	.145		.032	Belleville
BB29-137044	=Stainless-Steel-410	1.355/1.375	.692/.702	.088		.044	Belleville
BB29-137067	=Stainless-Steel-410	1.355/1.375	.692/.702	.101		.067	Belleville
BB29-125048	=Stainless-Steel-410	1.252	.751	.093		.048	Belleville
BB29-125050	=Stainless-Steel-410	1.250	.752	.142		.050	Belleville
BB29-125045	=Stainless-Steel-410	1.250	.754	.100		.045	Belleville
BB30-150045	=Stainless-Steel-410	1.480/1.500	.755/.756	.093		.045	Belleville
BB30-150060	=Stainless-Steel-410	1.480/1.500	.755/.765	.102		.060	Belleville
BB30-150072	=Stainless-Steel-410	1.480/1.500	.755/.765	.107		.072	Belleville
BB30-225102	=Stainless-Steel-410	2.230/2.250	.755/.765	.153		.102	Belleville
BB30-125058	=Stainless-Steel-410	1.250	.760	.140		.058	Belleville
BB30-149058	=Stainless-Steel-410	1.490	.781	.119		.058	Belleville
BB32-175057	=Stainless-Steel-410	1.730/1.750	.880/.890	.114		.057	Belleville
BB32-175085	=Stainless-Steel-410	1.730/1.750	.880/.890	.128		.085	Belleville
BB34-200065	=Stainless-Steel-410	1.980/2.000	1.000/1.020	.130		.065	Belleville
BB34-200097	=Stainless-Steel-410	1.980/2.000	1.000/1.020	.145		.097	Belleville
BB34-300135	=Stainless-Steel-410	2.980/3.000	1.000/1.020	.202		.135	Belleville
BB34-199095	=Stainless-Steel-410	1.995	1.062	.156		.095	Belleville
BB36-225073	=Stainless-Steel-410	2.230/2.250	1.125/1.145	.148		.073	Belleville
BB36-225111	=Stainless-Steel-410	2.230/2.250	1.125/1.145	.165		.111	Belleville

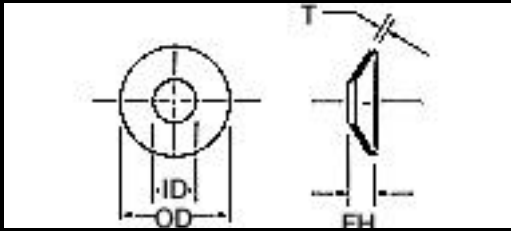

# SUPERIOR

WASHER & GASKET CORP.

Part Number	Material	OD	ID	Free HT	Size	Thickness	
BB38-250080	=Stainless-Steel-410	2.480/2.500	1.250/1.270	.160		.080	Belleville
BB38-250120	=Stainless-Steel-410	2.480/2.500	1.250/1.270	.180		.120	Belleville
BB38-375168	=Stainless-Steel-410	3.730/3.750	1.250/1.270	.251		.168	Belleville
BB40-275087	=Stainless-Steel-410	2.730/2.750	1.375/1.395	.173		.087	Belleville
BB40-275132	=Stainless-Steel-410	2.730/2.750	1.375/1.395	.196		.132	Belleville
BB42-300093	=Stainless-Steel-410	2.980/3.000	1.500/1.520	.189		.093	Belleville
BB42-300143	=Stainless-Steel-410	2.980/3.000	1.500/1.520	.213		.143	Belleville