

# TABLE OF CONTENTS

## STAND OFF SPACERS

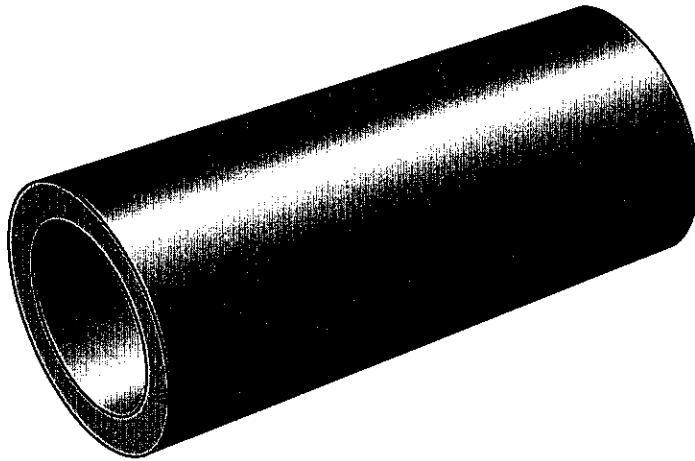

MATERIAL TYPE	PAGE NO.
ALUMINUM .....	148
LINEN PHENOLIC (LE) .....	150
NYLON .....	152

FOR MATERIAL INFORMATION, SEE ENGINEERING  
TABLES BEGINNING ON PAGE 543.

# STAND OFF SPACERS ALUMINUM

*Custom Sizes Available . . . See Last Page of This Section*

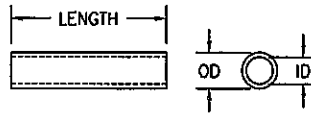

**NOTE:** Unless stated, all catalog parts are supplied without finish. See page 541 for specifying finishes.

PART NUMBER	SCREW SIZE	I.D. ± .010	O.D. ± .010	LENGTH ± .010
5795-2	4	.125	.250	.125
5795-3	4	.125	.250	.187
5795-4	4	.125	.250	.250
5795-5	4	.125	.250	.312
5795-6	4	.125	.250	.375
5795-7	4	.125	.250	.438
5795-8	4	.125	.250	.500
5795-9	4	.125	.250	.562
5795-10	4	.125	.250	.625
5795-11	4	.125	.250	.688
5795-12	4	.125	.250	.750
5795-13	4	.125	.250	.812
5795-14	4	.125	.250	.875
5795-15	4	.125	.250	.938
5795-16	4	.125	.250	1.000
5795-20	4	.125	.250	1.250
5795-24	4	.125	.250	1.500
5795-42	6	.156	.250	.125
5795-43	6	.156	.250	.187
5795-44	6	.156	.250	.250
5795-45	6	.156	.250	.312
5795-46	6	.156	.250	.375
5795-47	6	.156	.250	.438
5795-48	6	.156	.250	.500
5795-49	6	.156	.250	.562
5795-50	6	.156	.250	.625
5795-51	6	.156	.250	.688
5795-52	6	.156	.250	.750
5795-53	6	.156	.250	.812
5795-54	6	.156	.250	.875
5795-55	6	.156	.250	.938
5795-56	6	.156	.250	1.000
5795-60	6	.156	.250	1.250
5795-64	6	.156	.250	1.500
5795-82	8	.187	.312	.125
5795-83	8	.187	.312	.187
5795-84	8	.187	.312	.250
5795-85	8	.187	.312	.312
5795-86	8	.187	.312	.375
5795-87	8	.187	.312	.438

# STAND OFF SPACERS

## ALUMINUM *(Continued)*

*Custom Sizes Available . . . See Last Page of This Section*

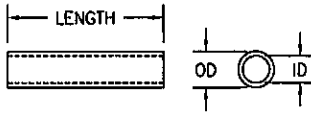

**NOTE:** Unless stated, all catalog parts are supplied without finish. See page 541 for specifying finishes.

PART NUMBER	SCREW SIZE	I.D. ± .010	O.D. ± .010	LENGTH ± .010
5795-88	8	.187	.312	.500
5795-89	8	.187	.312	.562
5795-90	8	.187	.312	.625
5795-91	8	.187	.312	.688
5795-92	8	.187	.312	.750
5795-93	8	.187	.312	.812
5795-94	8	.187	.312	.875
5795-95	8	.187	.312	.938
5795-96	8	.187	.312	1.000
5795-100	8	.187	.312	1.250
5795-104	8	.187	.312	1.500

Solder Lugs

Spring Clips

Spring Washers

Shoulder Washers

Stand Off Spacers

Flat Round Washers – Metallic

Flat Round Washers – Non-Metallic

O-Rings

Retaining Rings

Lockwashers, Retention Washers & Push-on Nuts

Clamps & Brackets

Expansion Plugs

Ground Straps, Bus Bars & Term. Blocks

Tab & Notch Washers

Misc. Washers & Tags

Solid State Insulators

Military Standards

Custom Parts

Engineering Tables

Num. & Alpha. Index of Parts

# STAND OFF INSULATING SPACERS LINEN PHENOLIC (LE)

*Custom Sizes Available . . . See Last Page of This Section*

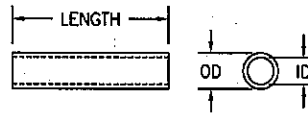

PART NUMBER	SCREW SIZE	I.D. + .005	O.D. + .010	LENGTH ± .010
5690-2-2	4	.125	.250	.125
5690-3-2	4	.125	.250	.187
5690-4-2	4	.125	.250	.250
5690-5-2	4	.125	.250	.312
5690-6-2	4	.125	.250	.375
5690-7-2	4	.125	.250	.437
5690-8-2	4	.125	.250	.500
5690-9-2	4	.125	.250	.562
5690-10-2	4	.125	.250	.625
5690-11-2	4	.125	.250	.688
5690-12-2	4	.125	.250	.750
5690-13-2	4	.125	.250	.812
5690-14-2	4	.125	.250	.875
5690-15-2	4	.125	.250	.938
5690-16-2	4	.125	.250	1.000
5690-20-2	4	.125	.250	1.250
5690-24-2	4	.125	.250	1.500
5690-28-2	4	.125	.250	1.750
5690-32-2	4	.125	.250	2.000
5691-2-2	6	.156	.250	.125
5691-3-2	6	.156	.250	.187
5691-4-2	6	.156	.250	.250
5691-5-2	6	.156	.250	.312
5691-6-2	6	.156	.250	.375
5691-7-2	6	.156	.250	.437
5691-8-2	6	.156	.250	.500
5691-9-2	6	.156	.250	.562
5691-10-2	6	.156	.250	.625
5691-11-2	6	.156	.250	.688
5691-12-2	6	.156	.250	.750
5691-13-2	6	.156	.250	.812
5691-14-2	6	.156	.250	.875
5691-15-2	6	.156	.250	.938
5691-16-2	6	.156	.250	1.000
5691-20-2	6	.156	.250	1.250
5691-24-2	6	.156	.250	1.500
5691-28-2	6	.156	.250	1.750
5691-32-2	6	.156	.250	2.000

# STAND OFF INSULATING SPACERS

## LINEN PHENOLIC (LE) *(Continued)*

*Custom Sizes Available . . . See Last Page of This Section*

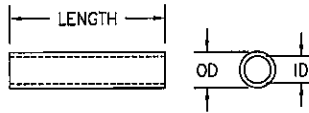

PART NUMBER	SCREW SIZE	I.D. + .005	O.D. + .010	LENGTH ± .010
5692-2-2	8	.187	.312	.125
5692-3-2	8	.187	.312	.187
5692-4-2	8	.187	.312	.250
5692-5-2	8	.187	.312	.312
5692-6-2	8	.187	.312	.375
5692-7-2	8	.187	.312	.438
5692-8-2	8	.187	.312	.500
5692-9-2	8	.187	.312	.562
5692-10-2	8	.187	.312	.625
5692-11-2	8	.187	.312	.688
5692-12-2	8	.187	.312	.750
5692-13-2	8	.187	.312	.812
5692-14-2	8	.187	.312	.875
5692-15-2	8	.187	.312	.938
5692-16-2	8	.187	.312	1.000
5692-20-2	8	.187	.312	1.250
5692-24-2	8	.187	.312	1.500
5692-28-2	8	.187	.312	1.750
5692-32-2	8	.187	.312	2.000

Solder Lugs

Spring Clips

Spring Washers

Shoulder Washers

Stand Off Spacers

Flat Round Washers - Metallic

Flat Round Washers - Non-Metallic

O-Rings

Retaining Rings

Lockwashers, Retention Washers & Push-on Nuts

Clamps & Brackets

Expansion Plugs

Ground Straps, Bus Bars & Term. Blocks

Tab & Notch Washers

Misc. Washers & Tags

Solid State Insulators

Military Standards

Custom Parts

Engineering Tables

Num. & Alpha. Index of Parts

# STAND OFF INSULATING SPACERS NYLON

*Custom Sizes Available . . . See Last Page of This Section*

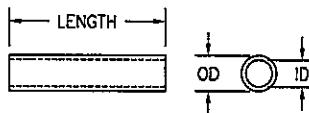

PART NUMBER	SCREW SIZE	I.D. ± .005	O.D. ± .015	LENGTH ± .015
5693-1	2	.091	.187	.125
5693-2	2	.091	.187	.187
5693-3	2	.091	.187	.250
5693-4	2	.091	.187	.312
5693-5	2	.091	.187	.375
5693-6	2	.091	.187	.437
5693-7	2	.091	.187	.500
5693-8	2	.091	.187	.562
5693-9	2	.091	.187	.625
5693-10	2	.091	.187	.687
5693-11	2	.091	.187	.750
5693-12	2	.091	.187	.812
5693-13	2	.091	.187	.875
5693-14	2	.091	.187	.937
5693-15	2	.091	.187	1.000
5693-16	2	.091	.250	.125
5693-17	2	.091	.250	.187
5693-18	2	.091	.250	.250
5693-19	2	.091	.250	.312
5693-20	2	.091	.250	.375
5693-21	2	.091	.250	.437
5693-22	2	.091	.250	.500
5693-23	2	.091	.250	.562
5693-24	2	.091	.250	.625
5693-25	2	.091	.250	.687
5693-26	2	.091	.250	.750
5693-27	2	.091	.250	.812
5693-28	2	.091	.250	.875
5693-29	2	.091	.250	.937
5693-30	2	.091	.250	1.000
5693-31	4	.115	.187	.125
5693-32	4	.115	.187	.187
5693-33	4	.115	.187	.250
5693-34	4	.115	.187	.312
5693-35	4	.115	.187	.375
5693-36	4	.115	.187	.437
5693-37	4	.115	.187	.500
5693-38	4	.115	.187	.562
5693-39	4	.115	.187	.625
5693-40	4	.115	.187	.687

# STAND OFF INSULATING SPACERS

## NYLON *(Continued)*

*Custom Sizes Available . . . See Last Page of This Section*

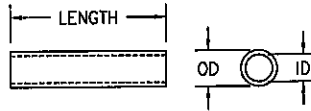

PART NUMBER	SCREW SIZE	I.D. ± .005	O.D. ± .015	LENGTH ± .015
5693-41	4	.115	.187	.750
5693-42	4	.115	.187	.812
5693-43	4	.115	.187	.875
5693-44	4	.115	.187	.937
5693-45	4	.115	.187	1.000
5693-46	4	.115	.250	.125
5693-47	4	.115	.250	.187
5693-48	4	.115	.250	.250
5693-49	4	.115	.250	.312
5693-50	4	.115	.250	.375
5693-51	4	.115	.250	.437
5693-52	4	.115	.250	.500
5693-53	4	.115	.250	.562
5693-54	4	.115	.250	.625
5693-55	4	.115	.250	.687
5693-56	4	.115	.250	.750
5693-57	4	.115	.250	.812
5693-58	4	.115	.250	.875
5693-59	4	.115	.250	.937
5693-60	4	.115	.250	1.000
5693-61	4	.115	.250	1.062
5693-62	4	.115	.250	1.125
5693-63	4	.115	.250	1.187
5693-64	4	.115	.250	1.250
5693-65	4	.115	.250	1.312
5693-66	4	.115	.250	1.375
5693-67	4	.115	.250	1.437
5693-68	4	.115	.250	1.500
5693-69	4	.115	.312	.125
5693-70	4	.115	.312	.187
5693-71	4	.115	.312	.250
5693-72	4	.115	.312	.312
5693-73	4	.115	.312	.375
5693-74	4	.115	.312	.437
5693-75	4	.115	.312	.500
5693-76	4	.115	.312	.562
5693-77	4	.115	.312	.625
5693-78	4	.115	.312	.687
5693-79	4	.115	.312	.750
5693-80	4	.115	.312	.812

Solder Lugs

Spring Clips

Spring Washers

Shoulder Washers

Stand Off Spacers

Flat Round Washers - Metallic

Flat Round Washers - Non-Metallic

O-Rings

Retaining Rings

Lockwashers, Retention Washers & Push-on Nuts

Clamps & Brackets

Expansion Plugs

Ground Straps, Bus Bars & Term. Blocks

Tab & Notch Washers

Misc. Washers & Tags

Solid State Insulators

Military Standards

Custom Parts

Engineering Tables

Num. & Alpha. Index of Parts

# STAND OFF INSULATING SPACERS

## NYLON *(Continued)*

*Custom Sizes Available . . . See Last Page of This Section*

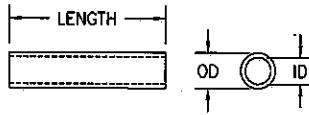

PART NUMBER	SCREW SIZE	I.D. ± .005	O.D. ± .015	LENGTH ± .015
5693-81	4	.115	.312	.875
5693-82	4	.115	.312	.937
5693-83	4	.115	.312	1.000
5693-84	4	.115	.312	1.062
5693-85	4	.115	.312	1.125
5693-86	4	.115	.312	1.187
5693-87	4	.115	.312	1.250
5693-88	4	.115	.312	1.312
5693-89	4	.115	.312	1.375
5693-90	4	.115	.312	1.437
5693-91	4	.115	.312	1.500
5693-92	6	.140	.250	.125
5693-93	6	.140	.250	.187
5693-94	6	.140	.250	.250
5693-95	6	.140	.250	.312
5693-96	6	.140	.250	.375
5693-97	6	.140	.250	.437
5693-98	6	.140	.250	.500
5693-99	6	.140	.250	.562
5693-100	6	.140	.250	.625
5693-101	6	.140	.250	.687
5693-102	6	.140	.250	.750
5693-103	6	.140	.250	.812
5693-104	6	.140	.250	.875
5693-105	6	.140	.250	.937
5693-106	6	.140	.250	1.000
5693-107	6	.140	.250	1.062
5693-108	6	.140	.250	1.125
5693-109	6	.140	.250	1.187
5693-110	6	.140	.250	1.250
5693-111	6	.140	.250	1.312
5693-112	6	.140	.250	1.375
5693-113	6	.140	.250	1.437
5693-114	6	.140	.250	1.500
5693-115	6	.140	.312	.125
5693-116	6	.140	.312	.187
5693-117	6	.140	.312	.250
5693-118	6	.140	.312	.312
5693-119	6	.140	.312	.375
5693-120	6	.140	.312	.437



# STAND OFF INSULATING SPACERS

## NYLON *(Continued)*

Custom Sizes Available . . . See Last Page of This Section

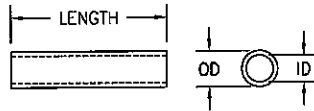

PART NUMBER	SCREW SIZE	I.D. ± .005	O.D. ± .015	LENGTH ± .015
5693-121	6	.140	.312	.500
5693-122	6	.140	.312	.562
5693-123	6	.140	.312	.625
5693-124	6	.140	.312	.687
5693-125	6	.140	.312	.750
5693-126	6	.140	.312	.812
5693-127	6	.140	.312	.875
5693-128	6	.140	.312	.937
5693-129	6	.140	.312	1.000
5693-130	6	.140	.312	1.062
5693-131	6	.140	.312	1.125
5693-132	6	.140	.312	1.187
5693-133	6	.140	.312	1.250
5693-134	6	.140	.312	1.312
5693-135	6	.140	.312	1.375
5693-136	6	.140	.312	1.437
5693-137	6	.140	.312	1.500
5693-138	6	.140	.375	.125
5693-139	6	.140	.375	.187
5693-140	6	.140	.375	.250
5693-141	6	.140	.375	.312
5693-142	6	.140	.375	.375
5693-143	6	.140	.375	.437
5693-144	6	.140	.375	.500
5693-145	6	.140	.375	.562
5693-146	6	.140	.375	.625
5693-147	6	.140	.375	.687
5693-148	6	.140	.375	.750
5693-149	6	.140	.375	.812
5693-150	6	.140	.375	.875
5693-151	6	.140	.375	.937
5693-152	6	.140	.375	1.000
5693-153	6	.140	.375	1.062
5693-154	6	.140	.375	1.125
5693-155	6	.140	.375	1.187
5693-156	6	.140	.375	1.250
5693-157	6	.140	.375	1.312
5693-158	6	.140	.375	1.375
5693-159	6	.140	.375	1.437
5693-160	6	.140	.375	1.500

Solder Lugs

Spring Clips

Spring Washers

Shoulder Washers

Stand Off Spacers

Flat Round Washers - Metallic

Flat Round Washers - Non-Metallic

O-Rings

Retaining Rings

Lockwashers, Retention Washers & Push-on Nuts

Clamps & Brackets

Expansion Plugs

Ground Straps, Bus Bars & Term. Blocks

Tab & Notch Washers

Misc. Washers & Tags

Solid State Insulators

Military Standards

Custom Parts

Engineering Tables

Num. & Alpha. Index of Parts

# STAND OFF INSULATING SPACERS

## NYLON *(Continued)*

*Custom Sizes Available . . . See Last Page of This Section*

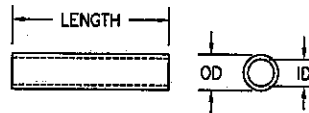

PART NUMBER	SCREW SIZE	I.D. ± .005	O.D. ± .015	LENGTH ± .015
5693-161	6	.140	.500	.125
5693-162	6	.140	.500	.187
5693-163	6	.140	.500	.250
5693-164	6	.140	.500	.312
5693-165	6	.140	.500	.375
5693-166	6	.140	.500	.437
5693-167	6	.140	.500	.500
5693-168	6	.140	.500	.562
5693-169	6	.140	.500	.625
5693-170	6	.140	.500	.687
5693-171	6	.140	.500	.750
5693-172	6	.140	.500	.812
5693-173	6	.140	.500	.875
5693-174	6	.140	.500	.937
5693-175	6	.140	.500	1.000
5693-176	8	.171	.250	.125
5693-177	8	.171	.250	.187
5693-178	8	.171	.250	.250
5693-179	8	.171	.250	.312
5693-180	8	.171	.250	.375
5693-181	8	.171	.250	.437
5693-182	8	.171	.250	.500
5693-183	8	.171	.250	.562
5693-184	8	.171	.250	.625
5693-185	8	.171	.250	.687
5693-186	8	.171	.250	.750
5693-187	8	.171	.250	.812
5693-188	8	.171	.250	.875
5693-189	8	.171	.250	.937
5693-190	8	.171	.250	1.000
5693-191	8	.171	.312	.125
5693-192	8	.171	.312	.187
5693-193	8	.171	.312	.250
5693-194	8	.171	.312	.312
5693-195	8	.171	.312	.375
5693-196	8	.171	.312	.437
5693-197	8	.171	.312	.500
5693-198	8	.171	.312	.562
5693-199	8	.171	.312	.625
5693-200	8	.171	.312	.687

# STAND OFF INSULATING SPACERS

## NYLON *(Continued)*

*Custom Sizes Available . . . See Last Page of This Section*

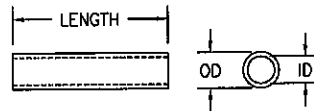

PART NUMBER	SCREW SIZE	I.D. ± .005	O.D. ± .015	LENGTH ± .015
5693-201	8	.171	.312	.750
5693-202	8	.171	.312	.812
5693-203	8	.171	.312	.875
5693-204	8	.171	.312	.937
5693-205	8	.171	.312	1.000
5693-206	8	.171	.312	1.062
5693-207	8	.171	.312	1.125
5693-208	8	.171	.312	1.187
5693-209	8	.171	.312	1.250
5693-210	8	.171	.312	1.312
5693-211	8	.171	.312	1.375
5693-212	8	.171	.312	1.437
5693-213	8	.171	.312	1.500
5693-214	8	.171	.375	.125
5693-215	8	.171	.375	.187
5693-216	8	.171	.375	.250
5693-217	8	.171	.375	.312
5693-218	8	.171	.375	.375
5693-219	8	.171	.375	.437
5693-220	8	.171	.375	.500
5693-221	8	.171	.375	.562
5693-222	8	.171	.375	.625
5693-223	8	.171	.375	.687
5693-224	8	.171	.375	.750
5693-225	8	.171	.375	.812
5693-226	8	.171	.375	.875
5693-227	8	.171	.375	.937
5693-228	8	.171	.375	1.000
5693-229	8	.171	.375	1.062
5693-230	8	.171	.375	1.125
5693-231	8	.171	.375	1.187
5693-232	8	.171	.375	1.250
5693-233	8	.171	.375	1.312
5693-234	8	.171	.375	1.375
5693-235	8	.171	.375	1.437
5693-236	8	.171	.375	1.500
5693-237	8	.171	.500	.125
5693-238	8	.171	.500	.187
5693-239	8	.171	.500	.250
5693-240	8	.171	.500	.312

Solder Lugs

Spring Clips

Spring Washers

Shoulder Washers

Stand Off Spacers

Flat Round Washers - Metallic

Flat Round Washers - Non-Metallic

O-Rings

Retaining Rings

Lockwashers, Retention Washers & Push-on Nuts

Clamps & Brackets

Expansion Plugs

Ground Straps, Bus Bars & Term. Blocks

Tab & Notch Washers

Misc. Washers & Tags

Solid State Insulators

Military Standards

Custom Parts

Engineering Tables

Num. & Alpha. Index of Parts

# STAND OFF INSULATING SPACERS

## NYLON *(Continued)*

*Custom Sizes Available . . . See Last Page of This Section*

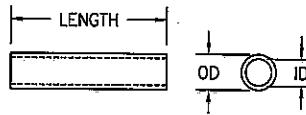

PART NUMBER	SCREW SIZE	I.D. ± .005	O.D. ± .015	LENGTH ± .015
5693-241	8	.171	.500	.375
5693-242	8	.171	.500	.437
5693-243	8	.171	.500	.500
5693-244	8	.171	.500	.562
5693-245	8	.171	.500	.625
5693-246	8	.171	.500	.687
5693-247	8	.171	.500	.750
5693-248	8	.171	.500	.812
5693-249	8	.171	.500	.875
5693-250	8	.171	.500	.937
5693-251	8	.171	.500	1.000
5693-252	10	.194	.312	.125
5693-253	10	.194	.312	.187
5693-254	10	.194	.312	.250
5693-255	10	.194	.312	.312
5693-256	10	.194	.312	.375
5693-257	10	.194	.312	.437
5693-258	10	.194	.312	.500
5693-259	10	.194	.312	.562
5693-260	10	.194	.312	.625
5693-261	10	.194	.312	.687
5693-262	10	.194	.312	.750
5693-263	10	.194	.312	.812
5693-264	10	.194	.312	.875
5693-265	10	.194	.312	.937
5693-266	10	.194	.312	1.000
5693-267	10	.194	.312	1.062
5693-268	10	.194	.312	1.125
5693-269	10	.194	.312	1.187
5693-270	10	.194	.312	1.250
5693-271	10	.194	.312	1.312
5693-272	10	.194	.312	1.375
5693-273	10	.194	.312	1.437
5693-274	10	.194	.312	1.500
5693-275	10	.194	.375	.125
5693-276	10	.194	.375	.187
5693-277	10	.194	.375	.250
5693-278	10	.194	.375	.312
5693-279	10	.194	.375	.375
5693-280	10	.194	.375	.437

# STAND OFF INSULATING SPACERS

## NYLON *(Continued)*

*Custom Sizes Available . . . See Last Page of This Section*

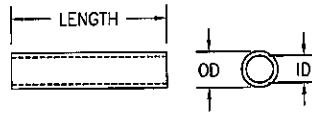

PART NUMBER	SCREW SIZE	I.D. ± .005	O.D. ± .015	LENGTH ± .015
5693-281	10	.194	.375	.500
5693-282	10	.194	.375	.562
5693-283	10	.194	.375	.625
5693-284	10	.194	.375	.687
5693-285	10	.194	.375	.750
5693-286	10	.194	.375	.812
5693-287	10	.194	.375	.875
5693-288	10	.194	.375	.937
5693-289	10	.194	.375	1.000
5693-290	10	.194	.375	1.062
5693-291	10	.194	.375	1.125
5693-292	10	.194	.375	1.187
5693-293	10	.194	.375	1.250
5693-294	10	.194	.375	1.312
5693-295	10	.194	.375	1.375
5693-296	10	.194	.375	1.437
5693-297	10	.194	.375	1.500
5693-298	10	.194	.500	.125
5693-299	10	.194	.500	.187
5693-300	10	.194	.500	.250
5693-301	10	.194	.500	.312
5693-302	10	.194	.500	.375
5693-303	10	.194	.500	.437
5693-304	10	.194	.500	.500
5693-305	10	.194	.500	.562
5693-306	10	.194	.500	.625
5693-307	10	.194	.500	.687
5693-308	10	.194	.500	.750
5693-309	10	.194	.500	.812
5693-310	10	.194	.500	.875
5693-311	10	.194	.500	.937
5693-312	10	.194	.500	1.000
5693-313	12	.219	.500	.125
5693-314	12	.219	.500	.187
5693-315	12	.219	.500	.250
5693-316	12	.219	.500	.312
5693-317	12	.219	.500	.375
5693-318	12	.219	.500	.437
5693-319	12	.219	.500	.500
5693-320	12	.219	.500	.562

Solder Lugs

Spring Clips

Spring Washers

Shoulder Washers

Stand Off Spacers

Flat Round Washers - Metallic

Flat Round Washers - Non-Metallic

O-Rings

Retaining Rings

Lockwashers, Retention Washers & Push-on Nuts

Clamps & Brackets

Expansion Plugs

Ground Straps, Bus Bars & Term. Blocks

Tab & Notch Washers

Misc. Washers & Tags

Solid State Insulators

Military Standards

Custom Parts

Engineering Tables

Num. & Alpha. Index of Parts

# STAND OFF INSULATING SPACERS

## NYLON *(Continued)*

*Custom Sizes Available . . . See Last Page of This Section*

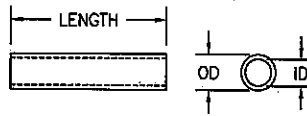

PART NUMBER	SCREW SIZE	I.D. ± .005	O.D. ± .015	LENGTH ± .015
5693-321	12	.219	.500	.625
5693-322	12	.219	.500	.687
5693-323	12	.219	.500	.750
5693-324	12	.219	.500	.812
5693-325	12	.219	.500	.875
5693-326	12	.219	.500	.937
5693-327	12	.219	.500	1.000
5693-328	1/4	.257	.500	.125
5693-329	1/4	.257	.500	.187
5693-330	1/4	.257	.500	.250
5693-331	1/4	.257	.500	.312
5693-332	1/4	.257	.500	.375
5693-333	1/4	.257	.500	.437
5693-334	1/4	.257	.500	.500
5693-335	1/4	.257	.500	.562
5693-336	1/4	.257	.500	.625
5693-337	1/4	.257	.500	.687
5693-338	1/4	.257	.500	.750
5693-339	1/4	.257	.500	.812
5693-340	1/4	.257	.500	.875
5693-341	1/4	.257	.500	.937
5693-342	1/4	.257	.500	1.000



# NEED SOMETHING CUSTOM?

See our custom parts section beginning on page 539. Use our FAX quote cover sheet and blank print to design the exact part you need and fax it to us. We'll give it our immediate attention.



**Seastrom**<sup>®</sup>

MANUFACTURERS OF QUALITY CUSTOM AND STANDARD PARTS SINCE 1928

## HOW TO REQUEST A FAX QUOTE:

### CUSTOM STAND OFF SPACERS

**If your application requires a custom stand off spacer with dimensions not listed in this catalog, simply photocopy the adjoining page, fill in all necessary dimensions, and fax it to us at 208-734-7222. It's that simple!**

Seastrom Manufacturing can custom manufacture virtually any custom stand off spacer you require.\*

For more information on materials — i.e. heat resistance, tensile strength, elasticity, etc. — please refer to the engineering tables section.

#### EXAMPLE

I.D.: <u>.125</u>	O.D.: <u>.250</u>	Length: <u>.750</u>
-------------------	-------------------	---------------------

\*If the configuration you require is different than shown on the adjoining page, please refer to the Custom Parts section for a fax quote cover sheet and a blank print to sketch your own design.

**If we can answer any questions concerning your custom stand off spacer needs, please feel free to call us today at 1-800-634-2356.**



# FAX QUOTE

## CUSTOM STAND OFF SPACERS

PLEASE FAX TO:

**SEASTROM MANUFACTURING COMPANY, INC. 208•734•7222**  
**ATTENTION: Inside Sales**

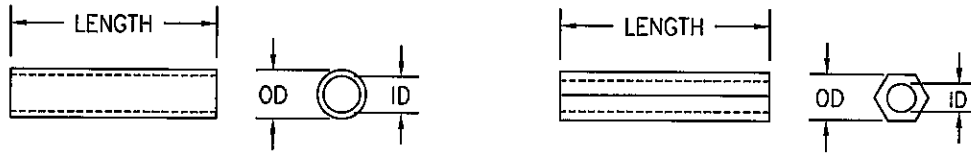

(CIRCLE ONE)

DATE \_\_\_\_\_

<b>I.D.:</b> _____	<b>O.D.:</b> _____	<b>Length:</b> _____
--------------------	--------------------	----------------------

UNLESS OTHERWISE SPECIFIED ALL DIMENSIONS WILL BE TO CATALOG TOLERANCES.\*

Material: \_\_\_\_\_

Plating: \_\_\_\_\_

Other Requirements: \_\_\_\_\_

**From:** \_\_\_\_\_ **Title:** \_\_\_\_\_

**Company:** \_\_\_\_\_

**Address:** \_\_\_\_\_ **City:** \_\_\_\_\_ **State:** \_\_\_ **Zip:** \_\_\_\_\_

**Phone:** \_\_\_\_\_ **Fax:** \_\_\_\_\_

<b>Please Quote the following:</b>	<i>For Seastrom Use</i>	
<b>QUANTITY</b>	<b>PRICE</b>	<b>DELIVERY</b>
<b>Estimated Yearly Usage:</b>		

DO NOT TEAR OUT ... PLEASE PHOTOCOPIY