

Type B Plain Washers

(1965 Draft Revision of American Standard B27.2 - 1958)

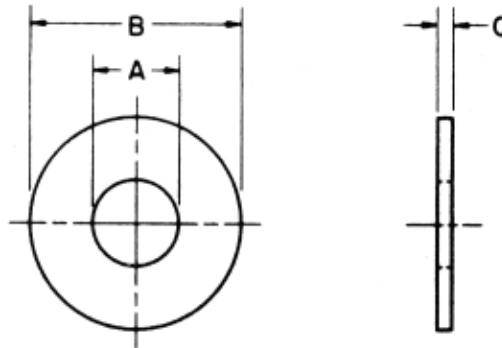

Nominal Washer Size ¹	Series	Inside Diameter A			Outside Diameter B			Thickness C		
		Basic	Tolerance		Basic	Tolerance		Basic	Max.	Min.
			Plus	Minus		Plus	Minus			
No. 0 (0.060)	Narrow	0.068	0.000	0.005	0.125	0.000	0.005	0.025	0.028	0.022
	Regular	0.068	0.000	0.005	0.188	0.000	0.005	0.025	0.028	0.022
	Wide	0.068	0.000	0.005	0.250	0.000	0.005	0.025	0.028	0.022
No. 1 (0.073)	Narrow	0.084	0.000	0.005	0.156	0.000	0.005	0.025	0.028	0.022
	Regular	0.084	0.000	0.005	0.219	0.000	0.005	0.025	0.028	0.022
	Wide	0.084	0.000	0.005	0.281	0.000	0.005	0.032	0.036	0.028
No. 2 (0.086)	Narrow	0.094	0.000	0.005	0.188	0.000	0.005	0.025	0.028	0.022
	Regular	0.094	0.000	0.005	0.250	0.000	0.005	0.032	0.036	0.028
	Wide	0.094	0.000	0.005	0.344	0.000	0.005	0.032	0.036	0.028
No. 3 (0.099)	Narrow	0.109	0.000	0.005	0.219	0.000	0.005	0.025	0.028	0.022
	Regular	0.109	0.000	0.005	0.312	0.000	0.005	0.032	0.036	0.028
	Wide	0.109	0.008	0.005	0.406	0.008	0.005	0.040	0.045	0.036
No. 4 (0.112)	Narrow	0.125	0.000	0.005	0.250	0.000	0.005	0.032	0.036	0.028
	Regular	0.125	0.008	0.005	0.375	0.008	0.005	0.040	0.045	0.036
	Wide	0.125	0.008	0.005	0.438	0.008	0.005	0.040	0.045	0.036
No. 5 (0.125)	Narrow	0.141	0.000	0.005	0.281	0.000	0.005	0.032	0.036	0.028
	Regular	0.141	0.008	0.005	0.406	0.008	0.005	0.040	0.045	0.036
	Wide	0.141	0.008	0.005	0.500	0.008	0.005	0.040	0.045	0.036
No. 6 (0.138)	Narrow	0.156	0.000	0.005	0.312	0.000	0.005	0.032	0.036	0.028
	Regular	0.156	0.008	0.005	0.438	0.008	0.005	0.040	0.045	0.036
	Wide	0.156	0.008	0.005	0.562	0.008	0.005	0.040	0.045	0.036
No. 8 (0.164)	Narrow	0.188	0.008	0.005	0.375	0.008	0.005	0.040	0.045	0.036
	Regular	0.188	0.008	0.005	0.500	0.008	0.005	0.040	0.045	0.036
	Wide	0.188	0.008	0.005	0.625	0.015	0.005	0.063	0.071	0.056
No. 10 (0.190)	Narrow	0.203	0.008	0.005	0.406	0.008	0.005	0.040	0.045	0.036
	Regular	0.203	0.008	0.005	0.562	0.008	0.005	0.040	0.045	0.036
	Wide	0.203	0.008	0.005	0.734*	0.015	0.007	0.063	0.071	0.056
No. 12 (0.216)	Narrow	0.234	0.008	0.005	0.438	0.008	0.005	0.040	0.045	0.036
	Regular	0.234	0.008	0.005	0.625	0.015	0.005	0.063	0.071	0.056
	Wide	0.234	0.008	0.005	0.875	0.015	0.007	0.063	0.071	0.056
1/4 (0.250)	Narrow	0.281	0.015	0.005	0.500	0.015	0.005	0.063	0.071	0.056
	Regular	0.281	0.015	0.005	0.734*	0.015	0.007	0.063	0.071	0.056
	Wide	0.281	0.015	0.005	1.000	0.015	0.007	0.063	0.071	0.056

¹The decimal equivalent of the numbered sizes and both the decimal and fractional dimension of all other sizes represent the basic diameter of the screw or bolt that should be used with the washer.

*The 0.734 in. outside diameter avoids washers which could be used in coin operated devices.

Inside and outside diameters shall be concentric within at least the inside diameter tolerance.

Washers shall be flat within 0.005 in. for basic outside diameters up to and including 0.875 in. and within 0.010 in. for larger outside diameters.

For larger sizes see Pages 5 and 6.

See Introductory Notes on Page 11.

Type B Plain Washers

(1965 Draft Revision of American Standard B27.2 - 1958)

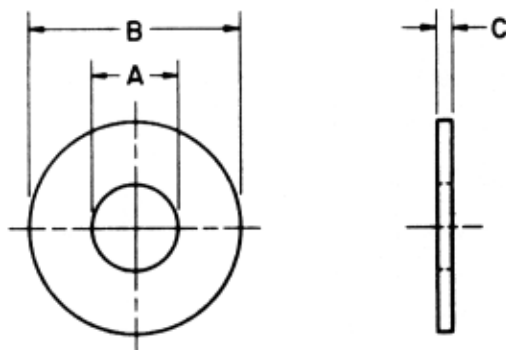

Nominal Washer Size ¹	Series	Inside Diameter A			Outside Diameter B			Thickness C		
		Basic	Tolerance		Basic	Tolerance		Basic	Max.	Min.
			Plus	Minus		Plus	Minus			
5/16 (0.312)	Narrow	0.344	0.015	0.005	0.625	0.015	0.005	0.063	0.071	0.056
	Regular	0.344	0.015	0.005	0.875	0.015	0.007	0.063	0.071	0.056
	Wide	0.344	0.015	0.005	1.125	0.015	0.007	0.063	0.071	0.056
3/8 (0.375)	Narrow	0.406	0.015	0.005	0.734*	0.015	0.007	0.063	0.071	0.056
	Regular	0.406	0.015	0.005	1.000	0.015	0.007	0.063	0.071	0.056
	Wide	0.406	0.015	0.005	1.250	0.030	0.007	0.100	0.112	0.090
7/16 (0.438)	Narrow	0.469	0.015	0.005	0.875	0.015	0.007	0.063	0.071	0.056
	Regular	0.469	0.015	0.005	1.125	0.015	0.007	0.063	0.071	0.056
	Wide	0.469	0.015	0.005	1.469*	0.030	0.007	0.100	0.112	0.090
1/2 (0.500)	Narrow	0.531	0.015	0.005	1.000	0.015	0.007	0.063	0.071	0.056
	Regular	0.531	0.015	0.005	1.250	0.030	0.007	0.100	0.112	0.090
	Wide	0.531	0.015	0.005	1.750	0.030	0.007	0.100	0.112	0.090
9/16 (0.562)	Narrow	0.594	0.015	0.005	1.125	0.015	0.007	0.063	0.071	0.056
	Regular	0.594	0.015	0.005	1.469*	0.030	0.007	0.100	0.112	0.090
	Wide	0.594	0.015	0.005	2.000	0.030	0.007	0.100	0.112	0.090
5/8 (0.625)	Narrow	0.656	0.030	0.007	1.250	0.030	0.007	0.100	0.112	0.090
	Regular	0.656	0.030	0.007	1.750	0.030	0.007	0.100	0.112	0.090
	Wide	0.656	0.030	0.007	2.250	0.030	0.007	0.160	0.174	0.146
3/4 (0.750)	Narrow	0.812	0.030	0.007	1.375	0.030	0.007	0.100	0.112	0.090
	Regular	0.812	0.030	0.007	2.000	0.030	0.007	0.100	0.112	0.090
	Wide	0.812	0.030	0.007	2.500	0.030	0.007	0.160	0.174	0.146
7/8 (0.875)	Narrow	0.938	0.030	0.007	1.469*	0.030	0.007	0.100	0.112	0.090
	Regular	0.938	0.030	0.007	2.250	0.030	0.007	0.160	0.174	0.146
	Wide	0.938	0.030	0.007	2.750	0.030	0.007	0.160	0.174	0.146
1 (1.000)	Narrow	1.062	0.030	0.007	1.750	0.030	0.007	0.100	0.112	0.090
	Regular	1.062	0.030	0.007	2.500	0.030	0.007	0.160	0.174	0.146
	Wide	1.062	0.030	0.007	3.000	0.030	0.007	0.160	0.174	0.146
1-1/8 (1.125)	Narrow	1.188	0.030	0.007	2.000	0.030	0.007	0.100	0.112	0.090
	Regular	1.188	0.030	0.007	2.750	0.030	0.007	0.160	0.174	0.146
	Wide	1.188	0.030	0.007	3.250	0.030	0.007	0.160	0.174	0.146
1-1/4 (1.250)	Narrow	1.312	0.030	0.007	2.250	0.030	0.007	0.160	0.174	0.146
	Regular	1.312	0.030	0.007	3.000	0.030	0.007	0.160	0.174	0.146
	Wide	1.312	0.045	0.010	3.500	0.045	0.010	0.250	0.266	0.234

¹The decimal equivalent of the numbered sizes and both the decimal and fractional dimension of all other sizes represent the basic diameter of the screw or bolt that should be used with the washer.

*The 0.734 in. and 1.469 in. outside diameters avoid washers which could be used in coin operated devices.

Inside and outside diameters shall be concentric within at least the inside diameter tolerance.

Washers shall be flat within 0.005 in. for basic outside diameters up to and including 0.875 in., and within 0.010 in. for larger outside diameters.

For larger sizes see Page 6.

See Introductory Notes on Page 1.



electronic fasteners inc.

Type B Plain Washers

(1965 Draft Revision of American Standard B27.2 - 1958)

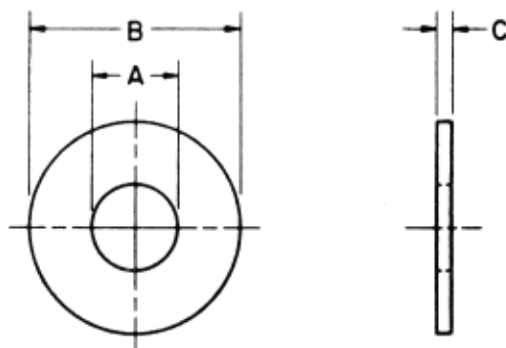

Nominal Washer Size ¹	Series	Inside Diameter A			Outside Diameter B			Thickness C		
		Basic	Tolerance		Basic	Tolerance		Basic	Max.	Min.
			Plus	Minus		Plus	Minus			
1-3/8 (1.375)	Narrow	1.438	0.030	0.007	2.500	0.030	0.007	0.160	0.174	0.146
	Regular	1.438	0.030	0.007	3.250	0.030	0.007	0.160	0.174	0.146
	Wide	1.438	0.045	0.010	3.750	0.045	0.010	0.250	0.266	0.234
1-1/2 (1.500)	Narrow	1.562	0.030	0.007	2.750	0.030	0.007	0.160	0.174	0.146
	Regular	1.562	0.045	0.010	3.500	0.045	0.010	0.250	0.266	0.234
	Wide	1.562	0.045	0.010	4.000	0.045	0.010	0.250	0.266	0.234
1-5/8 (1.625)	Narrow	1.750	0.030	0.007	3.000	0.030	0.007	0.160	0.174	0.146
	Regular	1.750	0.045	0.010	3.750	0.045	0.010	0.250	0.266	0.234
	Wide	1.750	0.045	0.010	4.250	0.045	0.010	0.250	0.266	0.234
1-3/4 (1.750)	Narrow	1.875	0.030	0.007	3.250	0.030	0.007	0.160	0.174	0.146
	Regular	1.875	0.045	0.010	4.000	0.045	0.010	0.250	0.266	0.234
	Wide	1.875	0.045	0.010	4.500	0.045	0.010	0.250	0.266	0.234
1-7/8 (1.875)	Narrow	2.000	0.045	0.010	3.500	0.045	0.010	0.250	0.266	0.234
	Regular	2.000	0.045	0.010	4.250	0.045	0.010	0.250	0.266	0.234
	Wide	2.000	0.045	0.010	4.750	0.045	0.010	0.250	0.266	0.234
2 (2.000)	Narrow	2.125	0.045	0.010	3.750	0.045	0.010	0.250	0.266	0.234
	Regular	2.125	0.045	0.010	4.500	0.045	0.010	0.250	0.266	0.234
	Wide	2.125	0.045	0.010	5.000	0.045	0.010	0.250	0.266	0.234
2-1/4 (2.250)	Narrow	2.375	0.045	0.010	4.000	0.045	0.010	0.250	0.266	0.234
	Regular	2.375	0.045	0.010	5.000	0.045	0.010	0.250	0.266	0.234
	Wide	2.375	0.065	0.010	5.500	0.065	0.010	0.375	0.393	0.357
2-1/2 (2.500)	Narrow	2.625	0.045	0.010	4.500	0.045	0.010	0.250	0.266	0.234
	Regular	2.625	0.065	0.010	5.500	0.065	0.010	0.375	0.393	0.357
	Wide	2.625	0.065	0.010	6.000	0.065	0.010	0.375	0.393	0.357
2-3/4 (2.750)	Narrow	2.875	0.045	0.010	5.000	0.045	0.010	0.250	0.266	0.234
	Regular	2.875	0.065	0.010	6.000	0.065	0.010	0.375	0.393	0.357
	Wide	2.875	0.065	0.010	6.500	0.065	0.010	0.375	0.393	0.357
3 (3.000)	Narrow	3.125	0.065	0.010	5.500	0.065	0.010	0.375	0.393	0.357
	Regular	3.125	0.065	0.010	6.500	0.065	0.010	0.375	0.393	0.357
	Wide	3.125	0.065	0.010	7.000	0.065	0.010	0.375	0.393	0.357

¹The decimal equivalent of the numbered sizes and both the decimal and fractional dimension of all other sizes represent the basic diameter of the screw or bolt that should be used with the washer.

Inside and outside diameters shall be concentric within at least the inside diameter tolerance.

Washers of sizes shown above shall be flat within 0.010 in.

See Introductory Notes on Page 1.