

# SPIROL®

## COILED PINS FOR PLASTIC HINGES

**The unique flexibility of the Series 550 coiled pin makes it the ideal fastener for light duty plastic hinge applications.**

- Uniform radial spring force results in controlled hinge movement and a hinge quality that remains consistent over time. No stress concentrations to fail or relax as with solid pins.
- Controlled hinge movement is achieved with wider tolerances and lower molding costs than with a solid pin or rivet.
- Chamfer accommodates misalignment and diameter variations of mating parts during insertion.
- Low insertion force and compression of pin during installation minimize hinge stress and scrap.
- Pin flexes upon impact, absorbing shock and minimizing stress on the hinge.
- Manufactured from AISI 302/304 work hardened stainless steel and supplied oil-free.



***Your customers  
will notice  
the difference!***

### DESIGN CONSIDERATIONS AND SPECIFICATIONS

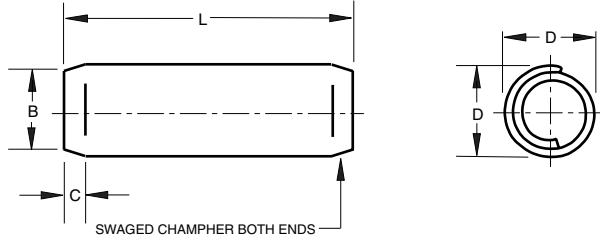

Standard Material	Standard Finish
<b>D</b> Nickel Stainless Steel AISI 302/304 Work Hardened	<b>F</b> Plain - Oil Free

### DIMENSIONAL DATA - METRIC

Nominal Diameter	Dim. "D" Pin Diameter		Dim. "B" Chamfer Dia.	Dim. "C" Chamfer Length (Ref.)	Recommended Hole Diameter		Dim. "L" Standard Lengths (Tolerance = ±.25)			
	Max.	Min.			Max.	Min.	10	12	14	16
1.2	1.35	1.27	1.15	.40	1.22	1.19				
1.5	1.68	1.60	1.40	.50	1.53	1.49				
1.55	1.73	1.65	1.45	.50	1.58	1.54				
1.6	1.78	1.70	1.50	.60	1.63	1.59				

**Part Description:** Nominal Dia. x Length, Material, Finish, "Series 550"

**Ordering Example:** 1.5 x 10 DF Series 550

Standard Lengths - Intermediate and longer lengths available upon request.

### PIN INSTALLATION

Spirol manufactures customized pin insertion equipment in support of its spring pin and solid pin product lines. Our machines are designed based on a modular concept of standard parts and subassemblies resulting in greater reliability, lower cost and faster delivery.

### Our capabilities include:

- Single or dual insertion
- Horizontal or vertical orientation
- Drilling and/or pinning
- Custom designed systems

Whatever your assembly requirements, we are dedicated to providing the best and most cost-effective solution.



**CHALLENGE US!**

#### SPIROL INTERNATIONAL CORP.

30 Rock Avenue  
Danielson, CT 06239-1434 U.S.A.  
860-774-8571  
Fax 860-774-0487  
information@spirol.com  
www.spirol.com



All coiled pins are manufactured at Spirol International in Danielson, CT.

ISO 9002 Certificate No. 5981

#### SPIROL WEST, INC.

645 E. Harrison Street., Suite 100  
Corona, CA 92879-1347 U.S.A.  
909-273-5900  
Fax 909-273-5907  
information@spirolwest.com  
www.spirolwest.com



#### SPIROL INDUSTRIES, LTD.

3103 St. Etienne Blvd.  
Windsor, Ontario, N8W 5B1, CANADA  
519-974-3334  
Fax 519-974-6550  
information@spirolcanada.com  
www.spirolcanada.com



Certificate No. 582