

Internal and Heavy Internal Tooth Lock Washers

(1965 Draft Revision of American Standard B27.1 - 1958)

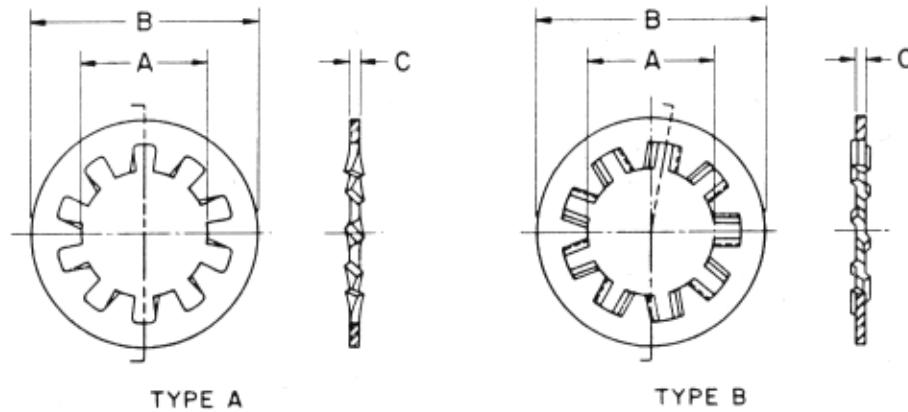

INTERNAL TOOTH LOCK WASHERS

Nominal Washer Size ¹	A		B		C	
	Inside Diameter		Outside Diameter		Thickness	
	Min.	Max.	Max.	Min.	Max.	Min.
No. 2 (0.086)	0.089	0.095	0.200	0.175	0.015	0.010
No. 3 (0.099)	0.102	0.109	0.232	0.215	0.019	0.012
No. 4 (0.112)	0.115	0.123	0.270	0.255	0.019	0.015
No. 5 (0.125)	0.129	0.136	0.280	0.245	0.021	0.017
No. 6 (0.138)	0.141	0.150	0.295	0.275	0.021	0.017
No. 8 (0.164)	0.168	0.176	0.340	0.325	0.023	0.018
No. 10 (0.190)	0.195	0.204	0.381	0.365	0.025	0.020
No. 12 (0.216)	0.221	0.231	0.410	0.394	0.025	0.020
1/4 (0.250)	0.256	0.267	0.478	0.460	0.028	0.023
5/16 (0.312)	0.320	0.332	0.610	0.594	0.034	0.028
3/8 (0.375)	0.384	0.398	0.692	0.670	0.040	0.032
7/16 (0.438)	0.448	0.464	0.789	0.740	0.040	0.032
1/2 (0.500)	0.512	0.530	0.900	0.867	0.045	0.037
9/16 (0.562)	0.576	0.596	0.985	0.957	0.045	0.037
5/8 (0.625)	0.640	0.663	1.071	1.045	0.050	0.042
11/16 (0.688)	0.704	0.728	1.166	1.130	0.050	0.042
3/4 (0.750)	0.769	0.795	1.245	1.220	0.055	0.047
13/16 (0.812)	0.832	0.861	1.315	1.290	0.055	0.047
7/8 (0.875)	0.894	0.927	1.410	1.364	0.060	0.052
1 (1.000)	1.019	1.060	1.637	1.590	0.067	0.059
1-1/8 (1.125)	1.144	1.192	1.830	1.799	0.067	0.059
1-1/4 (1.250)	1.275	1.325	1.975	1.921	0.067	0.059

HEAVY INTERNAL TOOTH LOCK WASHERS

Nominal Washer Size ¹	A		B		C	
	Inside Diameter		Outside Diameter		Thickness	
	Min.	Max.	Max.	Min.	Max.	Min.
1/4 (0.250)	0.256	0.267	0.536	0.500	0.045	0.035
5/16 (0.312)	0.320	0.332	0.607	0.590	0.050	0.040
3/8 (0.375)	0.384	0.398	0.748	0.700	0.050	0.042
7/16 (0.438)	0.448	0.464	0.858	0.800	0.067	0.050
1/2 (0.500)	0.512	0.530	0.924	0.880	0.067	0.055
9/16 (0.562)	0.576	0.596	1.034	0.990	0.067	0.055
5/8 (0.625)	0.640	0.663	1.135	1.100	0.067	0.059
3/4 (0.750)	0.768	0.795	1.265	1.240	0.084	0.070
7/8 (0.875)	0.894	0.927	1.447	1.400	0.084	0.075

¹ The decimal equivalent of the numbered sizes and both the decimal and fractional dimension of all other sizes represent the basic diameter of the screw or bolt that should be used with the washer.

See Introductory Notes on Page 7 and General Data for Tooth Lock Washers on Page 15.



electronic fasteners inc.

305 Winter Street • Waltham, Massachusetts 02254

305 Winter Street • Waltham, Massachusetts 02254

External Tooth Lock Washers

(1965 Draft Revision of American Standard B27.1 - 1958)

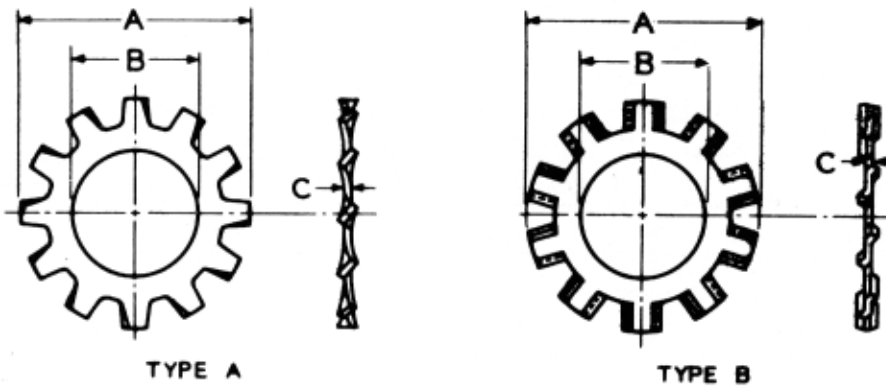

Nominal Washer Size ¹	A		B		C	
	Inside Diameter		Outside Diameter		Thickness	
	Min.	Max.	Max.	Min.	Max.	Min.
No. 4 (0.112)	0.115	0.123	0.260	0.245	0.019	0.015
No. 6 (0.138)	0.141	0.150	0.320	0.305	0.022	0.016
No. 8 (0.164)	0.168	0.176	0.381	0.365	0.023	0.018
No. 10 (0.190)	0.195	0.204	0.410	0.395	0.025	0.020
No. 12 (0.216)	0.221	0.231	0.475	0.460	0.028	0.023
1/4 (0.250)	0.256	0.267	0.510	0.494	0.028	0.023
5/16 (0.312)	0.320	0.332	0.610	0.588	0.034	0.028
3/8 (0.375)	0.384	0.398	0.694	0.670	0.040	0.032
7/16 (0.438)	0.448	0.464	0.760	0.740	0.040	0.032
1/2 (0.500)	0.513	0.530	0.900	0.880	0.045	0.037
9/16 (0.562)	0.576	0.596	0.985	0.960	0.045	0.037
5/8 (0.625)	0.641	0.663	1.070	1.045	0.050	0.042
11/16 (0.688)	0.704	0.728	1.155	1.130	0.050	0.042
3/4 (0.750)	0.768	0.795	1.260	1.220	0.055	0.047
13/16 (0.812)	0.833	0.861	1.315	1.290	0.055	0.047
7/8 (0.875)	0.897	0.927	1.410	1.380	0.060	0.052
1 (1.000)	1.025	1.060	1.620	1.590	0.067	0.059

¹The decimal equivalent of the numbered sizes and both the decimal and fractional dimension of all other sizes represent the basic diameter of the screw or bolt that should be used with the washer.

See Introductory Notes on Page 7 and General Data for Tooth Lock Washers on Page 15.



Countersunk External Tooth Lock Washers

(1965 Draft Revision of American Standard B27.1 - 1958)

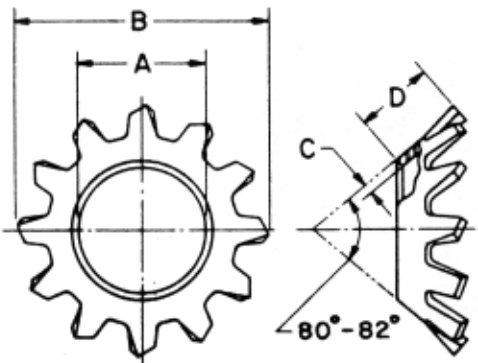

TYPE A

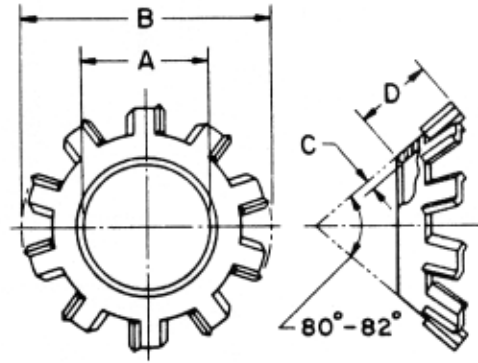

TYPE B

Nominal Washer Size ¹	A		B ²	C		D	
	Inside Diameter		Outside Diameter	Thickness		Length	
	Min.	Max.	Approx.	Max.	Min.	Max.	Min.
No. 4 (0.112)	0.113	0.123	0.213	0.019	0.015	0.065	0.050
No. 6 (0.138)	0.140	0.150	0.289	0.021	0.017	0.092	0.082
No. 8 (0.164)	0.167	0.177	0.322	0.021	0.017	0.105	0.088
No. 10 (0.190)	0.195	0.205	0.354	0.025	0.020	0.099	0.083
No. 12 (0.216)	0.220	0.231	0.421	0.025	0.020	0.128	0.118
1/4 (0.250)	0.255	0.267	0.454	0.025	0.020	0.128	0.113
No. 16 (0.268)	0.273	0.287	0.505	0.028	0.023	0.147	0.137
5/16 (0.312)	0.318	0.333	0.599	0.028	0.023	0.192	0.165
3/8 (0.375)	0.383	0.398	0.765	0.034	0.028	0.255	0.242
7/16 (0.438)	0.448	0.463	0.867	0.045	0.037	0.270	0.260
1/2 (0.500)	0.512	0.529	0.976	0.045	0.037	0.304	0.294

¹The decimal equivalent of the numbered sizes and both the decimal and fractional dimension of all other sizes represent the basic diameter of the screw or bolt that should be used with the washer.

²For reference purposes only.

See Introductory Notes on Page 7 and General Data for Tooth Lock Washers on Page 15.



electronic fasteners inc.

305 Winter Street • Waltham, Massachusetts 02254



Internal-External Tooth Lock Washers

(1965 Draft Revision of American Standard B27.1 - 1958)

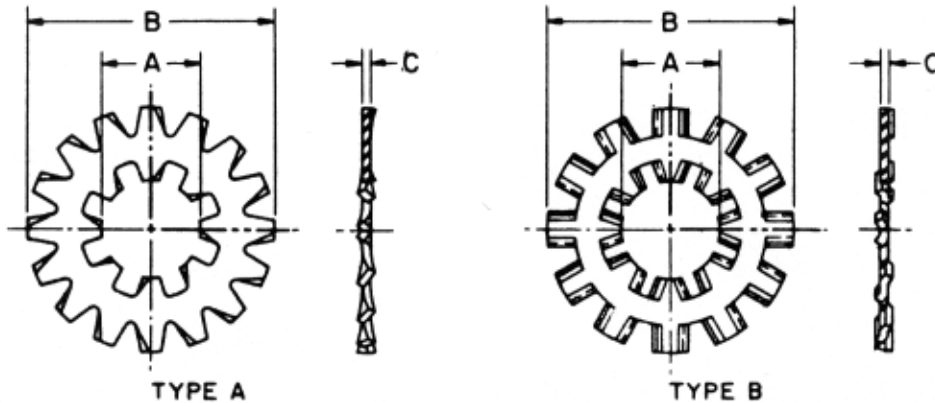

Nominal Washer Size ¹	A		B		C	
	Inside Diameter		Outside Diameter		Thickness	
	Min.	Max.	Max.	Min.	Max.	Min.
No. 4 (0.112)	0.115	0.123	0.475	0.460	0.021	0.017
			0.510	0.495	0.021	0.017
			0.610	0.580	0.021	0.017
No. 6 (0.138)	0.141	0.150	0.510	0.495	0.028	0.023
			0.610	0.580	0.028	0.023
			0.690	0.670	0.028	0.023
No. 8 (0.164)	0.168	0.176	0.610	0.580	0.034	0.028
			0.690	0.670	0.034	0.028
			0.760	0.740	0.034	0.028
No. 10 (0.190)	0.195	0.204	0.610	0.580	0.034	0.028
			0.690	0.670	0.040	0.032
			0.760	0.740	0.040	0.032
No. 12 (0.216)	0.221	0.231	0.900	0.880	0.040	0.032
			0.690	0.670	0.040	0.032
			0.760	0.725	0.040	0.032
1/4 (0.250)	0.256	0.267	0.900	0.880	0.040	0.032
			0.985	0.965	0.045	0.037
			1.070	1.045	0.045	0.037
5/16 (0.312)	0.320	0.332	0.900	0.865	0.040	0.032
			0.985	0.965	0.045	0.037
			1.070	1.045	0.050	0.042
3/8 (0.375)	0.384	0.398	1.155	1.130	0.050	0.042
			0.985	0.965	0.045	0.037
			1.070	1.045	0.050	0.042
7/16 (0.438)	0.448	0.464	1.155	1.130	0.050	0.042
			1.260	1.220	0.055	0.047
			1.315	1.290	0.055	0.047
1/2 (0.500)	0.512	0.530	1.260	1.220	0.055	0.047
			1.315	1.290	0.055	0.047
			1.410	1.380	0.060	0.052
9/16 (0.562)	0.576	0.596	1.620	1.590	0.067	0.059
			1.410	1.380	0.055	0.047
			1.430	1.380	0.060	0.052
5/8 (0.625)	0.640	0.663	1.620	1.590	0.067	0.059
			1.830	1.797	0.067	0.059
			1.410	1.380	0.060	0.052
			1.620	1.590	0.067	0.059
			1.830	1.797	0.067	0.059
			1.975	1.935	0.067	0.059

¹The decimal equivalent of the numbered sizes and both the decimal and fractional dimension of all other sizes represent the basic diameter of the screw or bolt that should be used with the washer. See Introductory Notes on Page 7 and General Data for Tooth Lock Washers on Page 15.

